



May 3, 2018

Contact: Joe Donnelly, Pete Peterson
Phone: (215) 862-7693, 215-990-8928

TRAVEL ADVISORY -- Overnights, Starting Monday

Overnight Closures and Detours to Start Monday Night At I-95/Route 29 Interchange near Scudder Falls Bridge

24/7 Detour of NJ Route 29 Southbound will commence next Thursday

EWING, NJ – Some travel lanes and ramps in the complex I-95/Route 29 interchange (Exit 1) are scheduled to be shut down and detoured during overnight periods beginning Monday, May 7, the Delaware River Joint Toll Bridge Commission announced today.

The scheduled ramp and roadway closures and corresponding detours are needed to allow for drainage installations in and around the NJ Route 29 interchange adjacent to the Scudder Falls Replacement Bridge.

Weather permitting, the following travel restrictions will begin on Monday, May 7:

- **NJ Route 29 North to I-95 South Ramp:** OVERNIGHTS from 10 p.m. Monday, May 7 to 6 a.m. (next day) the following Monday, May 14 (Weekends end time 7 a.m. Saturday, May 12 and 8 a.m. Sunday May 13). [Detour Map Available Here](#)
- **I-95 North to NJ Route 29 North Ramp:** OVERNIGHTS from 10 p.m. Monday, May 7 to 6 a.m. (next day) the following Monday, May 14 (Weekends end time 7 a.m. Saturday, May 12 and 8 a.m. Sunday May 13). [Detour Map Available Here](#)
- **NJ Route 29 South through I-95 Interchange:** 24/7 closure beginning 6 a.m. Thursday, May 10 through Tuesday, May 15 (Estimated End Date). [Detour Map Available Here](#)
- **I-95 South to NJ Route 29 South Ramp:** 24/7 closure beginning 6 a.m. Thursday, May 10 through Tuesday, May 15 (Estimated End Date). [Detour Map Available Here](#)

The aforementioned scheduled travel restrictions are subject to change due to weather, emergency, traffic, and equipment/materials mobilization considerations. Motorists are urged to allow extra time to reach their destinations, and to reduce speeds and exercise caution when travelling through project work areas.

More information on the Scudder Falls Bridge Replacement Project is available at www.scudderfallsbridge.com.

DETOUR MAPS ARE ALSO DISPLAYED BELOW



	Road Closed		Begin Detour
	Begin Road Closure		Detour of Route 29 north traffic for I-95 southbound

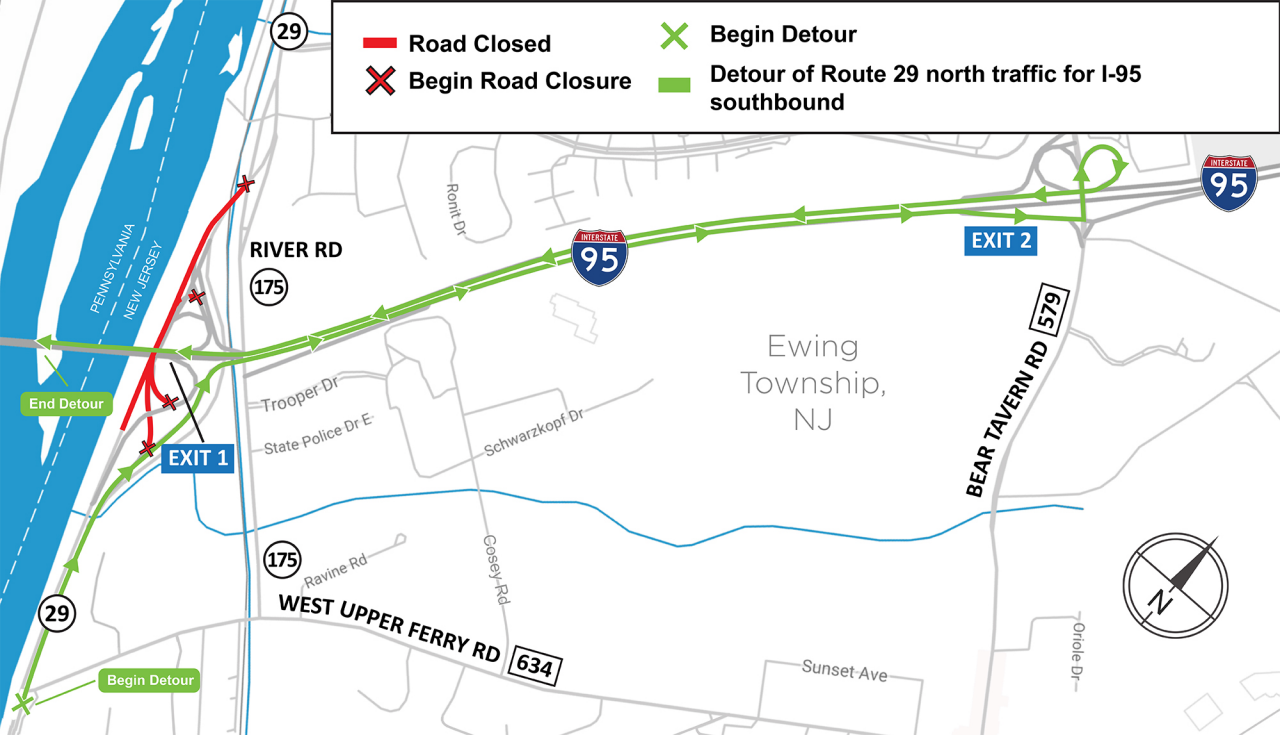

29

Road Closed

Begin Detour

Begin Road Closure

Detour of Route 29 north traffic for I-95 southbound



RIVER RD

175

EXIT 2



PENNSYLVANIA
NEW JERSEY

Ewing
Township,
NJ

End Detour

EXIT 1

BEAR TAVERN RD
579

175

WEST UPPER FERRY RD
634

29

Begin Detour



 Road Closed

 Begin Road Closure

 Begin Detour

 Detour of I-95 northbound traffic for Route 29 north

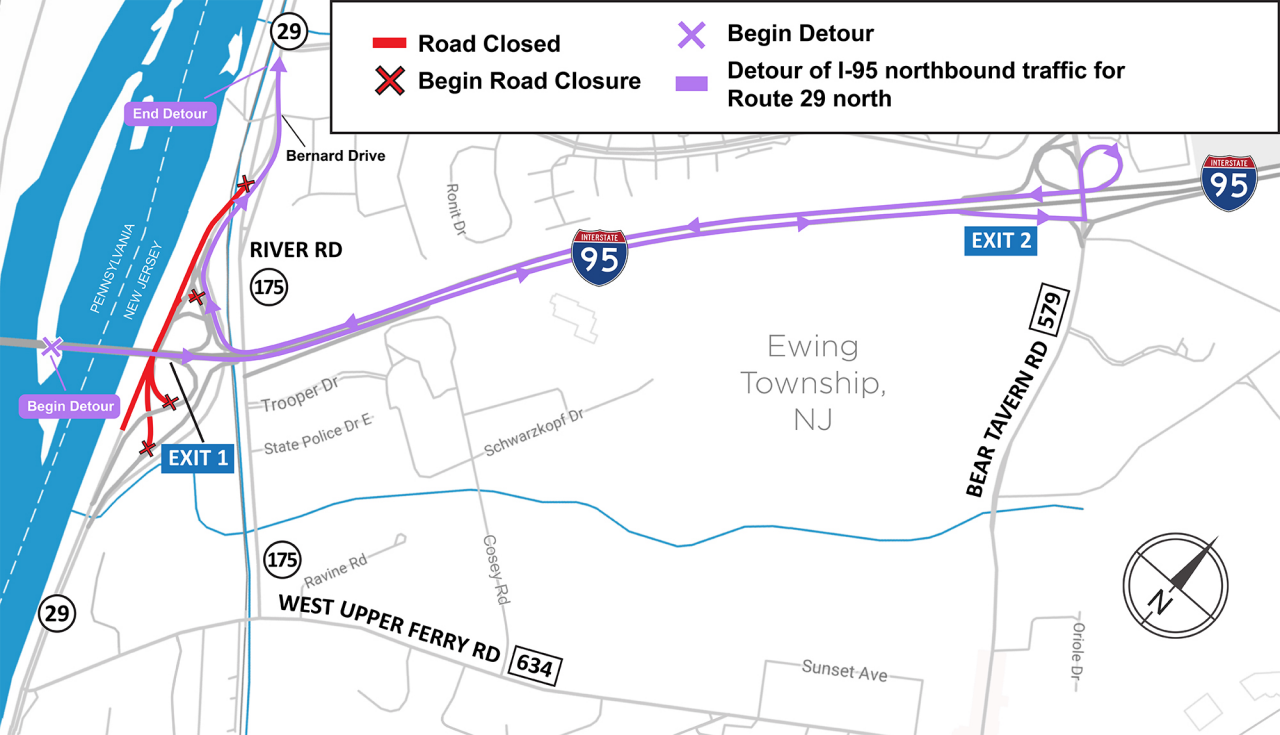

— Road Closed

✗ Begin Detour

✗ Begin Road Closure

— Detour of Route 29 south via Route 175



 Road Closed

 Begin Road Closure

 Begin Detour

 Detour of I-95 southbound traffic to Route 29 south

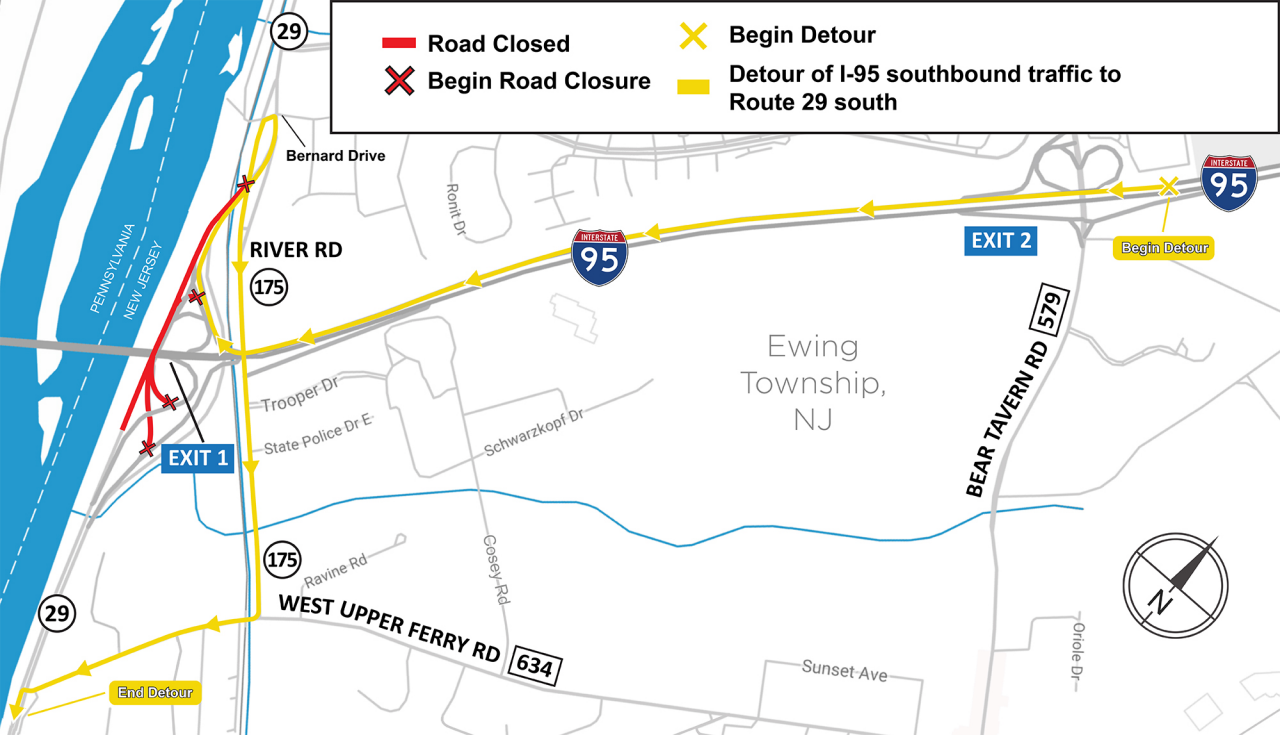

29

RIVER RD

175

EXIT 1

INTERSTATE 95

EXIT 2

Begin Detour

INTERSTATE 95

BEAR TAVERN RD 579

Ewing Township, NJ

175

WEST UPPER FERRY RD 634

29

End Detour

