



Aug. 11, 2018

Contact: Joe Donnelly, Pete Peterson
Phone: (215) 862-7693, 215-990-8928

TRAVEL ADVISORY – Week of August 12

Exit Ramp Closures, Traffic Shift, Off-Peak Lane Closures Next Week On Pennsylvania Side of Scudder Falls Bridge

Travel Changes to Allow for New Phase of Construction Activities

LOWER MAKFIELD, PA – As previously announced, a major shift of I-295 westbound (old I-95 south) traffic and a series of ramp closures and travel changes at the highway's Taylorsville Road interchange (Exit 10/Old Exit 51) will be phased in early next week on the Pennsylvania side of the Scudder Falls Bridge.

The new travel configurations will be carried out – weather permitting – over a 36-hour implementation period beginning 5 a.m. Monday, Aug. 13, and ending 5 p.m. Tuesday, Aug. 14. Some off-peak single-lane travel restrictions will be needed along I-295 westbound for the implementation to take place. Access to and from the westbound Pennsylvania Welcome Center/rest stop also could be suspended for brief periods.

Motorists traveling on I-295 west and through the Taylorsville Road interchange are advised to keep alert for new traffic patterns and new traffic signals and to allow extra time to reach their destinations. ([Please see accompanying map.](#)) The list of the upcoming travel changes are:

- I-295 westbound will be shifted to the left shortly after crossing into Pennsylvania on the Scudder Falls Bridge during the early morning hours of Tuesday, Aug. 14. The two shifted westbound lanes will run parallel to I-295 eastbound (old I-95 north) to a point roughly halfway between the Quarry Road overpass and the Yardley-Newtown Road/Route 332 interchange (Exit 8, old exit 49).
- The exit ramp from I-295 west to Taylorsville Road north (Exit 10B/New Hope) will be taken out of service permanently. This travel movement will be moved to a new temporary ramp on the other side of Taylorsville Road.
- The current exit ramp from I-295 west to Taylorsville Road south (Exit 10A/Yardley) will be taken out of service permanently. This travel movement will be moved to a new temporary ramp a short distance to the west.
- A new temporary exit ramp (new Exit 10) will be opened to handle I-295 westbound traffic exiting to both Taylorsville Road north and south. This ramp will start as a single lane but then flare out to two lanes. A newly installed traffic signal will control movements at the ramp's intersection with Taylorsville Road. A right-turn-on-red will be permitted for the ramp's right lane.
- On the south side of I-295 on Taylorsville Road a newly installed traffic signal will go live to control traffic movements where the exit ramp from I-295 eastbound (old I-95 north) intersects with Taylorsville Road.



- Portions of Taylorsville Road will be restriped to improve the flow of traffic onto and off of I-295 at the interchange ramps (Exit 10, old exit 51).
- New temporary ramps will be established along I-295 westbound to allow for entry into and out of the Pennsylvania Welcome Center (rest area).

The remaining schedule of Scudder Falls Bridge Replacement Project travel restrictions for the week of Aug. 12 will be as follows:

Pennsylvania side

- **I-295 east (old I-95 north) from the Route 332/Newtown-Yardley interchange (Exit 8, old exit 49) to the Scudder Falls Bridge** – Intermittent single-lane travel patterns 10 a.m. to 6 a.m. (next day) Monday, Aug. 13, through Friday, Aug. 17.
- **I-295 west (old I-95 south) from the Scudder Falls Bridge to the Route 332/Newtown-Yardley interchange (Exit 8, old edit 49)** – Intermittent single-lane travel patterns 8 p.m. to 2 p.m. (next day) Monday, Aug. 13, through Friday, Aug. 17.
- **Taylorsville Road in vicinity of I-295** - Intermittent single-lane patterns with possible flagger-controlled travel 10 a.m. to 6 p.m. Monday, Aug. 13, to Friday, Aug. 17; [new temporary traffic signals to go live early morning hours Tuesday, Aug. 14.](#)
- **Woodside Road (west of Taylorsville Road to around Clearview Drive)** – Right or left lane closures with passage maintained in each direction and/or flagging-controlled travel 10 a.m. to 6 p.m. Monday, Aug. 13, to Friday, Aug. 17.
- **River Road/Route 32** – Intermittent alternating single-lane travel with traffic controlled by flaggers 7 a.m. to 5 p.m. Monday, Aug. 13, to Friday, Aug. 17.

New Jersey side

- No noteworthy lane/ramp closures or travel restrictions for the week.

Weekends: Aside from the carryover of any Friday overnight closures into Saturdays, no other travel restrictions are scheduled for the weekends of Aug. 11-12 and 18-19.

Delaware Canal Towpath on PA side of Scudder Falls Bridge: The towpath for the Delaware Canal in Pennsylvania remains closed around the clock Mondays through Saturdays in the vicinity of the Scudder Falls Bridge Replacement Project construction zone (from Woodside Road to the southern project limits). Public access is Sundays-only through August.

The aforementioned scheduled travel restrictions are subject to change due to weather, emergency, traffic, and equipment/materials mobilization considerations. Motorists are urged to allow extra time to reach their destinations, and to reduce speeds and exercise caution when travelling through project work areas.

More information on the Scudder Falls Bridge Replacement Project is available at www.scudderfallsbridge.com.

I-295 WESTBOUND CONSTRUCTION CROSSOVER

- Work Area
- I-295 Westbound
- I-295 Eastbound
- Traffic Signals
- Temporary Exit 10 Ramp

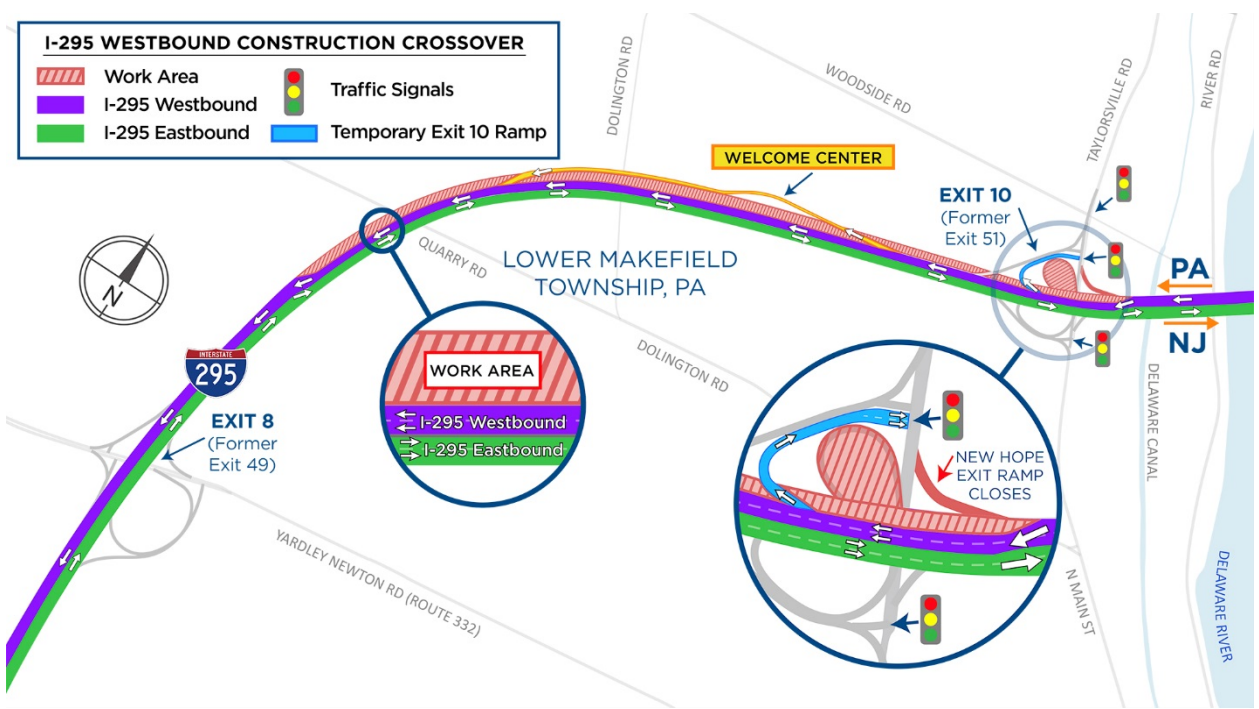

I-295 WESTBOUND CONSTRUCTION CROSSOVER

-  Work Area
-  I-295 Westbound
-  I-295 Eastbound
-  Traffic Signals
-  Temporary Exit 10 Ramp



INTERSTATE
295

EXIT 8
(Former Exit 49)

YARDLEY NEWTON RD (ROUTE 332)

QUARRY RD

LOWER MAKEFIELD TOWNSHIP, PA

DOLINGTON RD

WOODSIDE RD

WELCOME CENTER

EXIT 10
(Former Exit 51)

TAYLORSVILLE RD

RIVER RD

PA
NJ

DELAWARE CANAL

DELAWARE RIVER

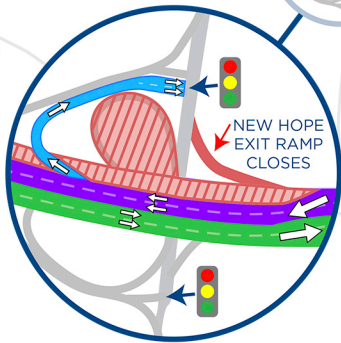
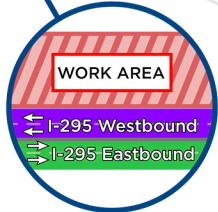

N MAIN ST